

# Indicator Lights (Neon, LED and Filament Lamp)

## Colours and voltages:

-  **Neon** Available with Red, Amber, Green or Clear lenses  
100/130V (marked 110V), 200/250V (marked 230V)
-  **LED - DC** Red, Yellow, Green, Blue, White  
2.0/2.2V Resistors for other voltages available.
-  **LED - AC** Red, Yellow, Green, Blue, White  
110-230V ac operation.
-  **Filament lamp** Available with Red, Amber, Green, Clear or Blue lenses  
6V, 12/14V, 24/28V.

- ▶ Neon, LED, mains LED or filament lamp
- ▶ Bezel sizes from 6.7 to 16.3mm dia
- ▶ Red, amber, green and clear lenses
- ▶ Red, yellow, green, blue and white LEDs
- ▶ Wide choice of styles

## To create a catalogue number:

Refer to the 2 columns below (terminal and type), then state: Lens colour, voltage and whether neon, LED or filament lamp











UL file E63363  
CSA file 1317844 / 1279633 ®

Approvals shown for neon versions only

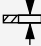

RoHS compliant

TERM	TYPE	PANEL & °C	ILLUMINATION OPTIONS
H 4.8 	<b>H 0581 AY</b>  	 18.2/18.3 6.2/6.3*  2.0-3.5  page 66	 
L 	<b>L 0195 00</b>  	 13.0x6.5  0.8-3.0  page 66	 
L  C 6.3 	<b>(C) 0196 AA</b>  	 13.0x6.5  0.8-3.0  page 66	 
L 	<b>L 0234 00</b>  	 9.27/9.50 4.75*  0.71-1.62  page 66	
L 	<b>L 0233 00</b>   page 66		

## DIMENSIONS (mm)

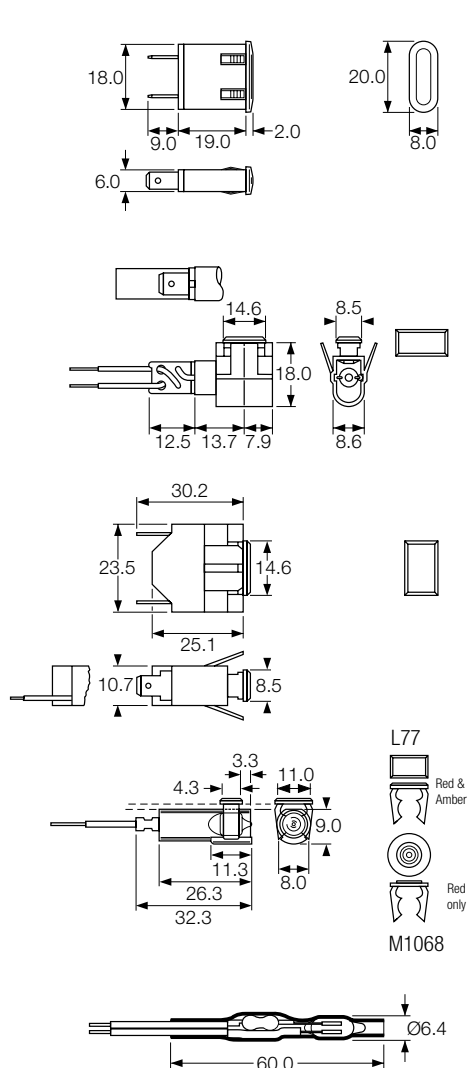

Neon tube, resistor and flexible lead assembly, protected by "shrunk on" transparent sleeving.